



Land at Shaft Road

Monkton Combe, Bath

Carter Jonas

Land at Shaft Road
Monkton Combe
Bath
BA2 7HJ

A unique opportunity to
purchase two paddocks
and a wooden stable in
Monkton Combe.

The land is situated on Shaft Road to the north
of Monkton Combe. The property includes two
paddocks and an area of hard standing with a
timber stable.

In all extending to 2.5 acres (1.01 ha).

For sale by private treaty as a whole.

Carter Jonas

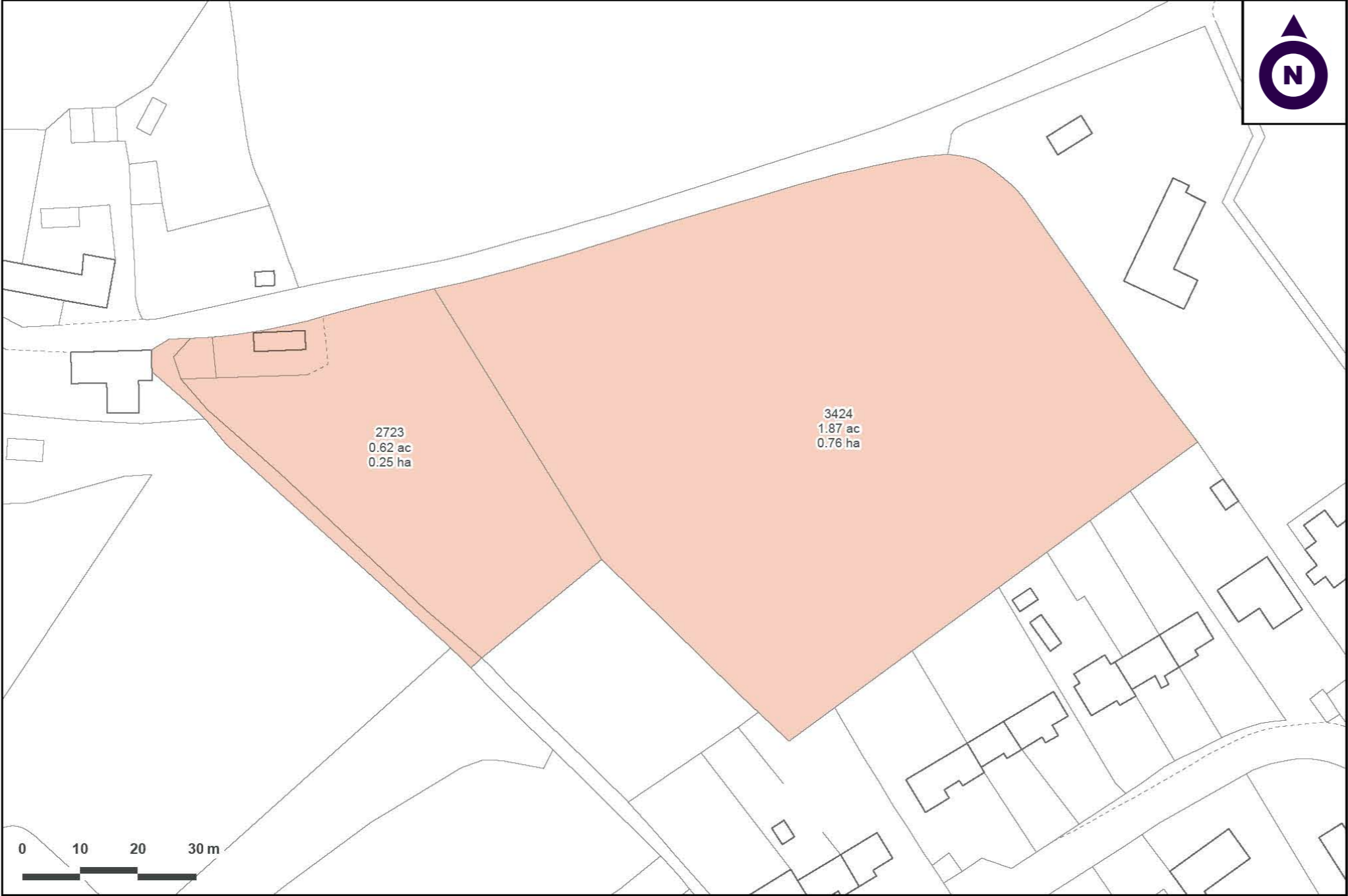

Property

The land at Monkton Combe is located to the north of the village and extends to 2.5 acres (1.01 ha). The land is split into two well sized paddocks and has been grazed in recent years. Access to the property can be gained from Shaft Road. There is a wooden field shelter and an area of hard standing to the north of the property. One half of the timber building is a store, and the other half an open fronted stable.

Location

The land is located to the north of Monkton Combe which is approximately 2.5 miles from Bath as the crow flies and 3.5 miles northwest of Bradford on Avon.

Method of Sale

The land is offered for sale by private treaty.

Tenure & Possession

Freehold with vacant possession on completion.

Designations

The land is situated in the Cotswolds Area of Outstanding Natural Beauty (AONB) and is located in the Avon Greenbelt.

Health & Safety

We ask that you be as vigilant as possible when making your inspections for your own personal safety.

Services

There is a mains water connection to the land

Wayleaves Easements & Rights of Way

The property is being sold subject to and with the benefit of all rights including; rights of way, whether public or private, light, drainage, water and electricity supplies and other rights and obligations, easements and quasi easements and restrictive covenants and all existing proposed wayleaves for masts, pylons, stays, cables, drains, water and gas and other pipes whether referred to in these particulars or not.

Local Authority

Bath and North East Somerset (BANES)
Bathnes.gov.uk

Viewings

Potential purchasers may view the land during reasonable daylight hours after informing the selling agents, Carter Jonas, on 0117 403 9970.

Directions

From Bath head south on A3062 until you reach Combe Down then turn left onto North Road then turn right onto Shaft Road until you reach the property.



/// gloves.jumped.bait



Bristol

0117 403 9972 | arthur.chambers@carterjonas.co.uk
07815 489 452 | ella.morrison@carterjonas.co.uk
St Catherine's Court, Berkeley Place, Bristol, BS8 1BQ

Important Information

These particulars are for general information purposes only and do not represent an offer or contract or part of one. Carter Jonas or anyone in their employment has made every attempt to ensure that the particulars and other information provided are as accurate as possible and they are not intended to amount to advice on which you should rely as being factually accurate. Full information which may be relevant to your decision regarding the property can be found on the property listing on carterjonas.co.uk or, (including off market properties) on the brochure or a separately available material information sheet. We would advise you to confirm the details of any material information prior to any offer being submitted. You should not assume that the property has all necessary planning, building regulations or other consents and Carter Jonas has not tested any services, facilities or equipment. Any measurements and distances given are approximate only. Where Carter Jonas has been provided with a floorplan by a third party, we cannot guarantee that the floorplan has been measured in accordance with IPMS. Purchasers must satisfy themselves of all of the aforementioned by independent inspection or otherwise. Our images only represent part of the property as it appeared at the time they were taken and do not represent the furnishings included; these are confirmed in a separate inventory. If you require further information, please contact us.

carterjonas.co.uk

Offices throughout the UK



Carter Jonas

Exclusive UK affiliate of
CHRISTIE'S
INTERNATIONAL REAL ESTATE