



Land at Street Drove

Glastonbury, Somerset

Carter Jonas

Land at Street Drove Glastonbury Somerset

11.95 acre (4.84 ha) block
of land for sale, located just
south of Glastonbury

Two conveniently sized land parcels on the
outskirts of Glastonbury

In all extending to 11.95 acres (4.84 ha).

The land is offered for sale by private treaty.

Carter Jonas

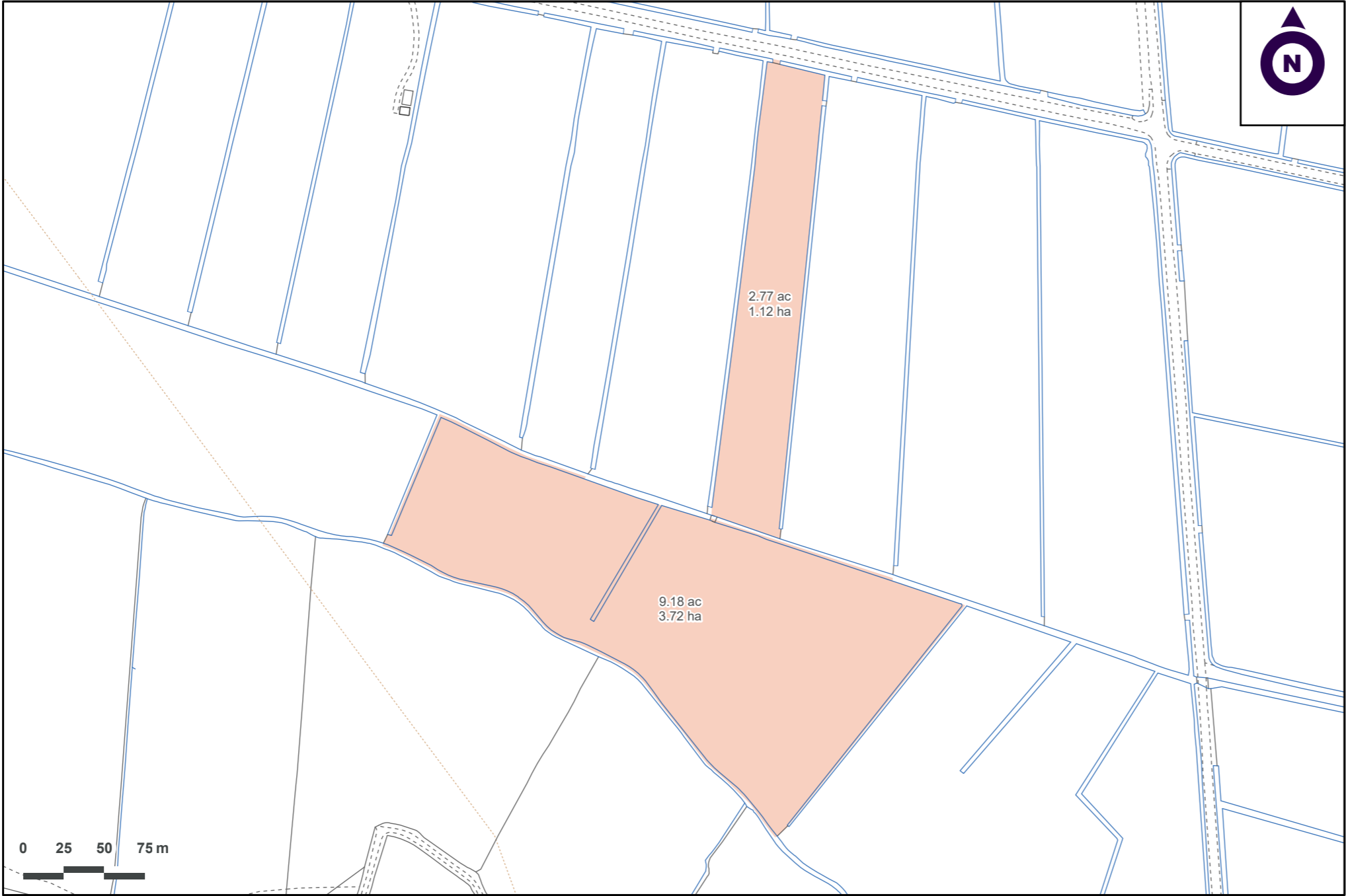

© Crown Copyright and database rights 2025 OS 100004458



Location

The land is located approximately 3 miles south of Glastonbury and 1 mile from the centre of Street. Bristol lies approximately 30 miles to the north.

Property

The first parcel extends to approximately 2.77 acres (1.12 ha) with direct access to a rhyne, providing a natural water source for livestock.

The second, larger parcel measures approximately 9.18 acres (3.72 ha) and runs parallel to the same rhyne. This parcel can be accessed via a wooden bridge connecting the two fields.

Both parcels have been grazed in recent years and present potential for a range of rural or agricultural purposes.

Method of Sale

The land is offered for sale by private treaty

Tenure & Possession

Freehold with vacant possession on completion.

Services

There are no current services on the land that we are aware of.

Wayleaves, Easements & Rights of Way

The property is being sold subject to and with the benefit of all rights including; rights of way, whether public or private, light, drainage, water and electricity supplies and other rights and obligations, easements and quasi easements and restrictive covenants and all existing proposed wayleaves for masts, pylons, stays, cables, drains, water and gas and other pipes whether referred to in these particulars or not.

There is a footpath on the southern boundary of the property.

Health & Safety

We ask that you be as vigilant as possible when making your inspections for your own personal safety.

Local Authority

Somerset Council

Viewings

Potential purchasers may view the land during reasonable daylight hours after informing the selling agents, Carter Jonas, on 0117 403 9970.

Directions

From Glastonbury, head South on Butleigh road until the crossroads, then turn right onto Street Drove. The land is approximately 500m down Street drove on the left-hand side.



/// helm.browsers.Influencing

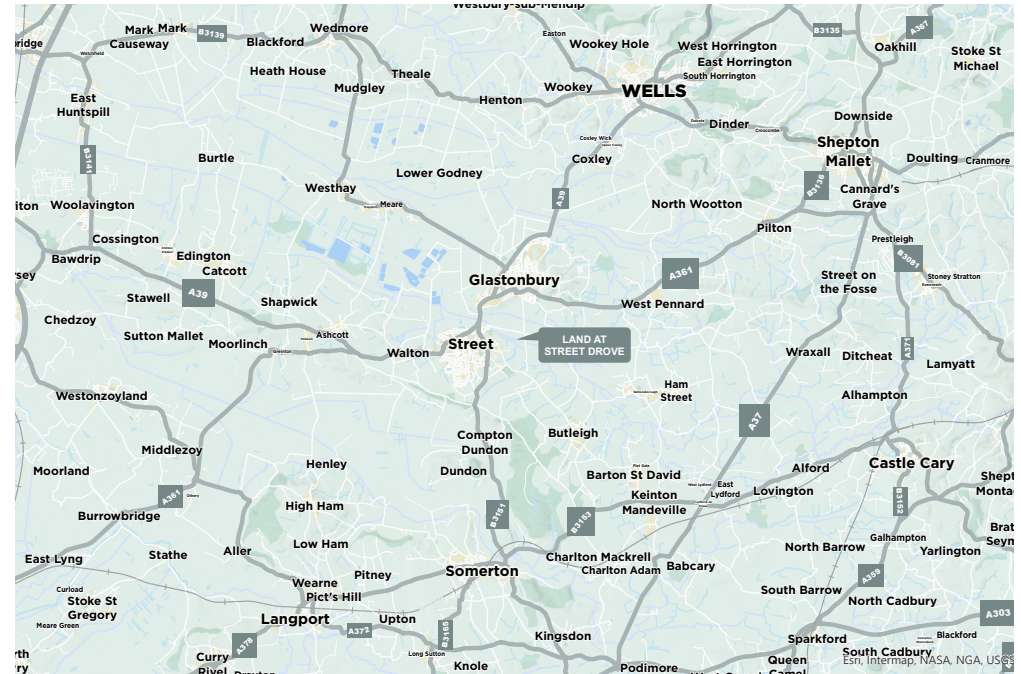

Bristol

0117 403 9972 | arthur.chambers@carterjonas.co.uk
07815 489 452 | ella.morrison@carterjonas.co.uk
St Catherine's Court, Berkeley Place, Bristol, BS8 1BQ

Important Information

These particulars are for general information purposes only and do not represent an offer or contract or part of one. Carter Jonas or anyone in their employment has made every attempt to ensure that the particulars and other information provided are as accurate as possible and they are not intended to amount to advice on which you should rely as being factually accurate. Full information which may be relevant to your decision regarding the property can be found on the property listing on carterjonas.co.uk or, (including off market properties) on the brochure or a separately available material information sheet. We would advise you to confirm the details of any material information prior to any offer being submitted. You should not assume that the property has all necessary planning, building regulations or other consents and Carter Jonas has not tested any services, facilities or equipment. Any measurements and distances given are approximate only. Where Carter Jonas has been provided with a floorplan by a third party, we cannot guarantee that the floorplan has been measured in accordance with IPMS. Purchasers must satisfy themselves of all of the aforementioned by independent inspection or otherwise. Our images only represent part of the property as it appeared at the time they were taken and do not represent the furnishings included; these are confirmed in a separate inventory. If you require further information, please contact us.

carterjonas.co.uk

Offices throughout the UK



Carter Jonas

Exclusive UK affiliate of
CHRISTIE'S
INTERNATIONAL REAL ESTATE