



Land at Watchwell Drove

Glastonbury, Somerset

**Carter Jonas**



Land at  
Watchwell Drove  
Glastonbury  
Somerset

14.3-acre (5.80 ha) block  
of land for sale located  
Southeast of Glastonbury.

A conveniently sized parcel of land situated  
just south of Glastonbury.

In all extending to 14.3 acres (5.80 ha).

The land is offered for sale by private treaty.

Carter Jonas

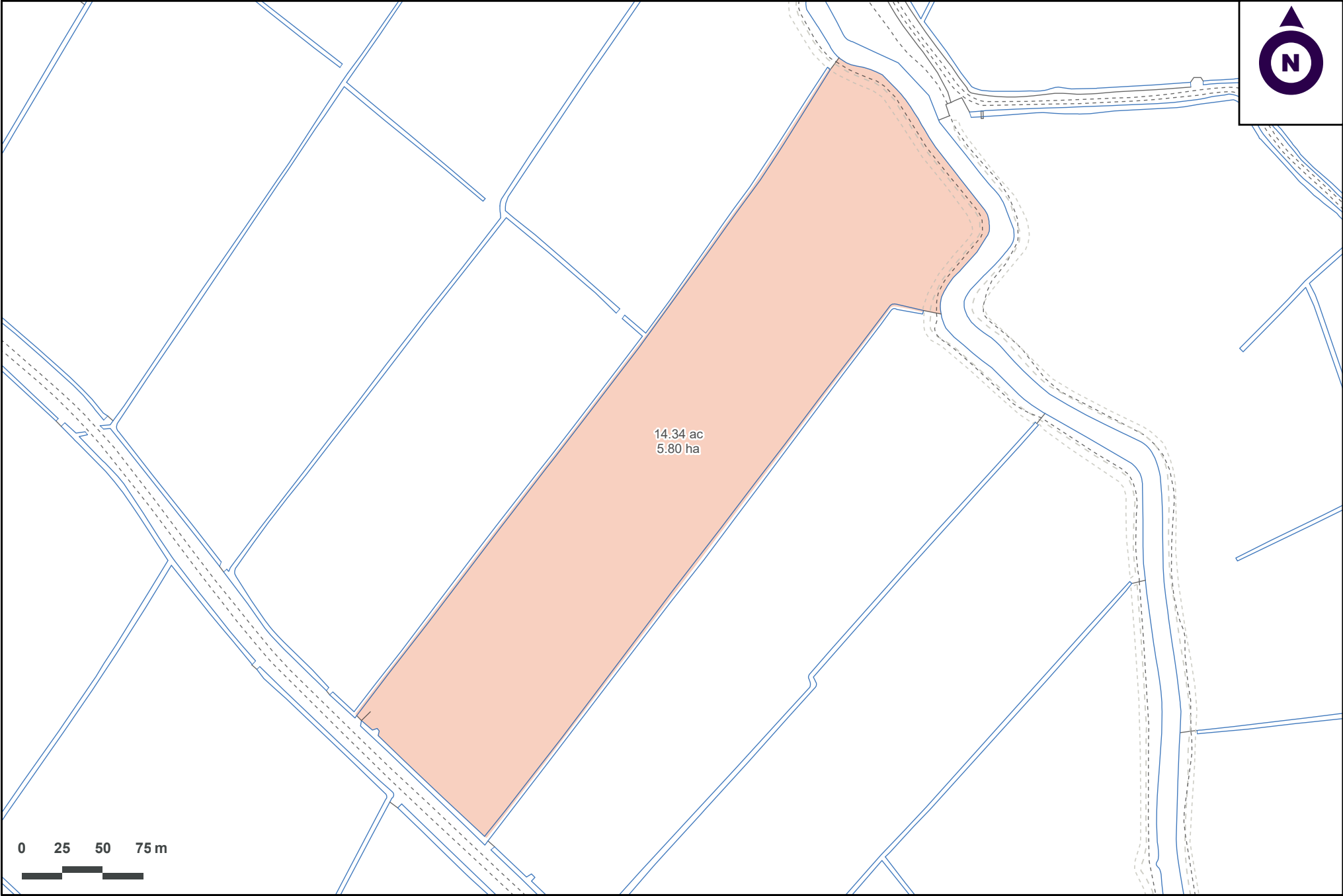

© Crown Copyright and database rights 2025 OS 100004458



Location

The land is located approximately 4 miles southeast of Glastonbury, and approximately 2.8 miles from the centre of Street village. Bristol is approximately 30 miles to the north.

Property

The land consists of a well sized field that has been used for grazing in recent years. Access to the property can be gained from Watchwell Drove Road.

## Method of Sale

The land is offered for sale by private treaty

## Tenure & Possession

Freehold with vacant possession on completion.

## Services

There are no current services on the land that we are aware of.

## Wayleaves, Easements & Rights of Way

The property is being sold subject to and with the benefit of all rights including; rights of way, whether public or private, light, drainage, water and electricity supplies and other rights and obligations, easements and quasi easements and restrictive covenants and all existing proposed wayleaves for masts, pylons, stays, cables, drains, water and gas and other pipes whether referred to in these particulars or not.

## Health & Safety

We ask that you be as vigilant as possible when making your inspections for your own personal safety.

## Local Authority

Somerset Council

## Viewings

Potential purchasers may view the land during reasonable daylight hours after informing the selling agents, Carter Jonas, on 0117 403 9970.

## Directions

From Glastonbury, proceed south along Butleigh Road until you reach the crossroads. At the crossroads, turn left onto Middle Drove Road. Continue for approximately 1.1 miles, where the plot of land will be located on the left-hand side of the road.



/// section.train.sped

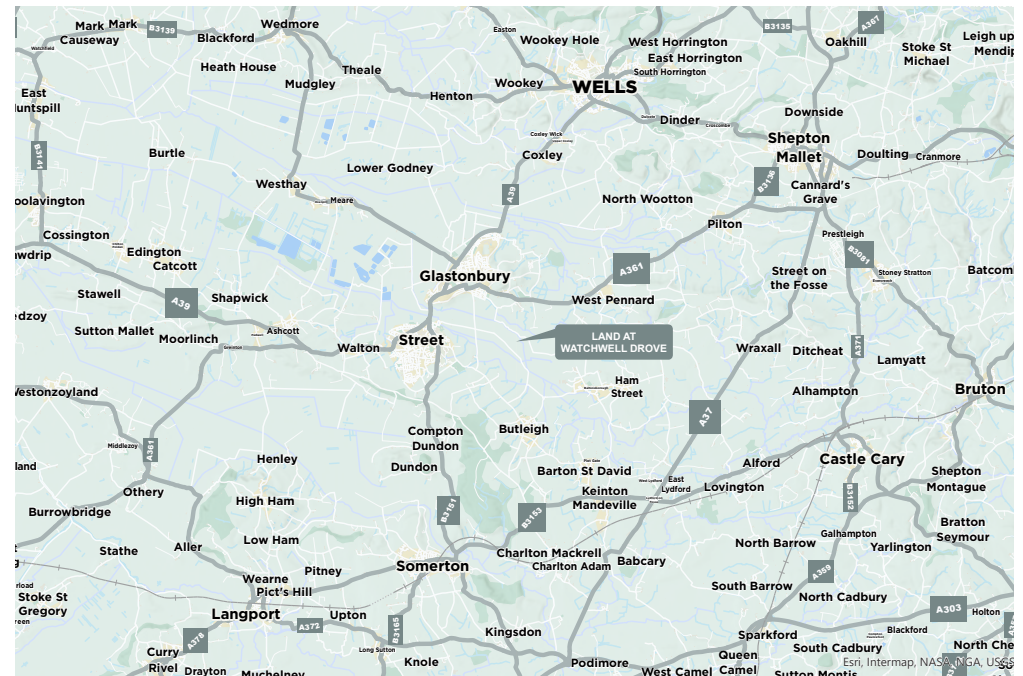

## Bristol

0117 403 9972 | [arthur.chambers@carterjonas.co.uk](mailto:arthur.chambers@carterjonas.co.uk)  
07815 489 452 | [ella.morrison@carterjonas.co.uk](mailto:ella.morrison@carterjonas.co.uk)  
St Catherine's Court, Berkeley Place, Bristol, BS8 1BQ

## Important Information

These particulars are for general information purposes only and do not represent an offer or contract or part of one. Carter Jonas or anyone in their employment has made every attempt to ensure that the particulars and other information provided are as accurate as possible and they are not intended to amount to advice on which you should rely as being factually accurate. Full information which may be relevant to your decision regarding the property can be found on the property listing on [carterjonas.co.uk](http://carterjonas.co.uk) or, (including off market properties) on the brochure or a separately available material information sheet. We would advise you to confirm the details of any material information prior to any offer being submitted. You should not assume that the property has all necessary planning, building regulations or other consents and Carter Jonas has not tested any services, facilities or equipment. Any measurements and distances given are approximate only. Where Carter Jonas has been provided with a floorplan by a third party, we cannot guarantee that the floorplan has been measured in accordance with IPMS. Purchasers must satisfy themselves of all of the aforementioned by independent inspection or otherwise. Our images only represent part of the property as it appeared at the time they were taken and do not represent the furnishings included; these are confirmed in a separate inventory. If you require further information, please contact us.

[carterjonas.co.uk](http://carterjonas.co.uk)

Offices throughout the UK



Carter Jonas

Exclusive UK affiliate of  
**CHRISTIE'S**  
INTERNATIONAL REAL ESTATE