



**BURY STREET, ST JAMES'S, SW1Y**  
£807.69 per week\*

**Carter Jonas**



---

# GEORGIAN HOUSE, BURY STREET, ST JAMES'S, LONDON,

A one-bedroom apartment of approximately 506 square feet

- Long Let
- Furnished
- 1 Bedroom
- 1 Reception room
- 1 Kitchen
- 1 Bathroom
- Porter
- Lift
- Heating and Hot water included

## THE PROPERTY

This refurbished apartment is situated in a period building with lift and caretaker, centrally located in St James's within walking distance of Piccadilly, Green Park and transport links.

## LOCATION

St James's is one of the most exclusive residential areas of London with its famous residences including Buckingham Palace, St James's Palace and Clarence House set amongst the open spaces of Green Park and St James's Park. Dominated by beautiful architecture, art and antique dealers and with some of the highest commercial rents in London, it is also home to many blue-chip companies and the best-known gentlemen's clubs frequented by English high society.

Nearest Tube: Green Park

AST

The deposit will be £4,038.45 at a rental value of £807.69 (asking price)

Holding deposit = 1 week's rent of £807.69

Deposit is 5 weeks rent (£807.69 pw = £4,038.45 deposit)





ADDITIONAL INFORMATION

|                      |   |
|----------------------|---|
| Offers               | Available for a minimum term of 12 months<br>longer terms will be considered        |
| Viewing              | Strictly by appointment   |
| Local Authority      | Westminster County Council - Council Tax Band E                                     |
| Material Information | Communal heating and hot water<br>Ultrafast broadband and mobile coverage available |

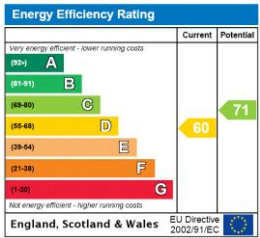



## GEORGIAN HOUSE

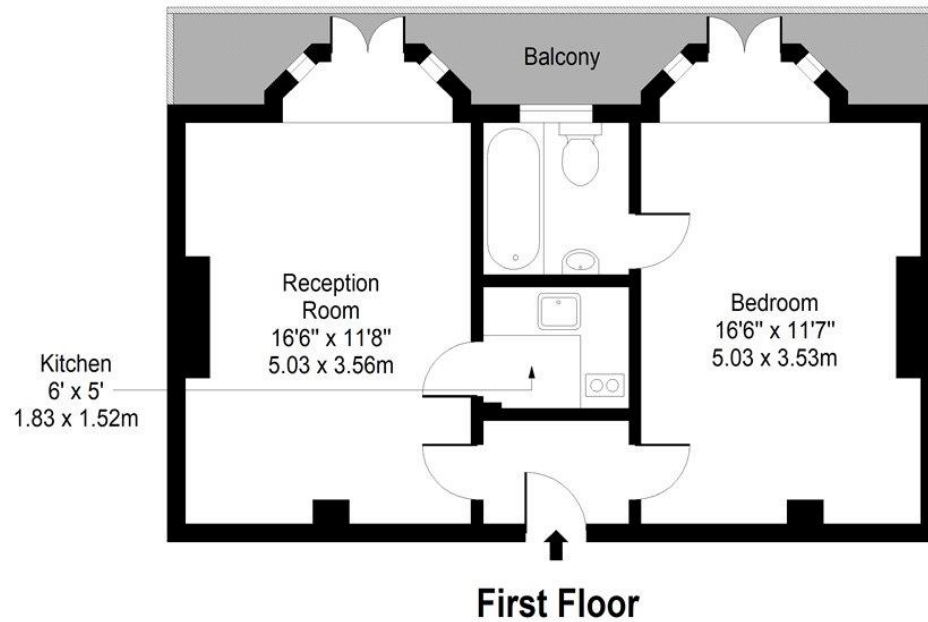
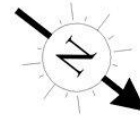

Approx. Gross Internal Area 529 Sq Ft - 49.14 Sq M  
For Illustrative Purposes Only - Not To Scale



**T: 020 7493 0676**

18 Davies Street, Mayfair, London, W1K 3DS  
E: [mayfair@carterjonas.co.uk](mailto:mayfair@carterjonas.co.uk)

**carterjonas.co.uk**  
Offices throughout the UK

A member of  
**onTheMarket.com**  
Classification L2 - Business Data

### IMPORTANT INFORMATION

Our property particulars do not represent an offer or contract, or part of one. The information given is without responsibility on the part of the agents, seller(s) or lessor(s) and you should not rely on the information as being factually accurate about the property, its condition, or its value. Neither Carter Jonas LLP nor anyone in its employment or acting on its behalf has authority to make any representation or warranty in relation to this property. We have not carried out a detailed survey, nor tested the services, appliances, or fittings at the property. The images shown may only represent part of the property and are as they appeared at the time of being photographed. The areas, measurements and distances are approximate only. Where Carter Jonas have been provided with a floorplan by a third party, we cannot guarantee that the floorplan has been measured in accordance with IPMS. Any reference to alterations or use does not mean that any necessary planning permission, building regulation or other consent has been obtained. The VAT position relating to the property may change without notice. Administration fees may apply depending on tenancy type. Please contact your local branch for this information.