



**SANDWATH DRIVE, CHURCH FENTON, LS24**  
£1,300 per month\*

**Carter Jonas**



# SANDWATH DRIVE, CHURCH FENTON, LS24

A modern four bedroom detached house with garage, garden and driveway parking.

Comprising: Entrance hall, Study, Dining Room, Sitting Room, Kitchen, Utility Room, Cloakroom WC. First Floor: Master Bedroom with en suite, 3 further Bedrooms. Family Bathroom. Garden, Garage and Driveway. Available January 2023. Unfurnished.

Council Tax Band E

Holding deposit = 1 weeks rent of £300

Deposit is 5 weeks rent (£1,300 pcm = £1,500 deposit)

- Council Tax Band = E
- Deposit Required = £1,500.00
- Garden
- Driveway Parking
- Garage
- Unfurnished
- EPC = C
- 4 Bedrooms
- Two Bathrooms

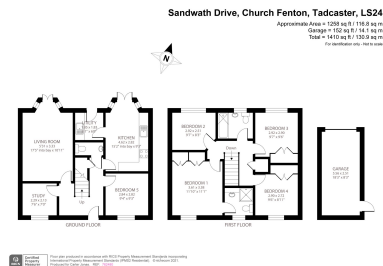
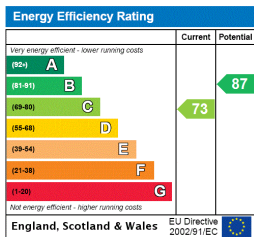

Oxford Lettings 01865 511444

oxford@carterjonas.co.uk

Mayfield House, 256 Banbury Road, Oxford, Oxfordshire, OX2 7DE

carterjonas.co.uk

Offices throughout the UK



L2 - Business



## IMPORTANT INFORMATION

These particulars are for general information purposes only and do not represent an offer or contract or part of one. Carter Jonas has made every attempt to ensure that the particulars and other information provided are as accurate as possible and are not intended to amount to advice on which you should rely as being factually accurate. You should not assume that the property has all necessary planning, building regulations or other consents and Carter Jonas have not tested any services, facilities or equipment. Any measurements and distances given are approximate only. Where Carter Jonas have been provided with a floorplan by a third party, we can not guarantee that the floorplan has been measured in accordance with IPMS. Purchasers or prospective tenants must satisfy themselves of all of the aforementioned by independent inspection or otherwise. Although we make reasonable efforts to update our information, neither Carter Jonas nor anyone in its employment or acting on its behalf makes any representations warranties or guarantees, whether express or implied, in relation to the property, or that the content in these particulars is accurate, complete or up to date. Our images only represent part of the property as it appeared at the time they were taken and do not represent the furnishings included, these are confirmed in a separate inventory. If you require further information please contact us.

\*Administration fees may apply depending on tenancy type. Please contact your local branch for this information.